

2025 Launch

# Google EDLA Certified



AI-Powered Teaching Assistant



- Explanation
- Image Search
- Video Recommendations
- Summarize Lecture
- Math Equation Solver
- Quick Quiz Generation
- Homework Generation

Ask me anything

Authentic Android 14 & Octa-Core Processor

Connected Classroom App

Google Play Protect Enhanced Security

3 Year on-site Warranty



# AI-Powered Teaching Assistant



Safest AI  
for Teaching

PHOTOSYNTHESIS

Photosynthesis

Sunlight

Carbon dioxide

Chlorophyll

Water

Oxygen is released

Glucose is formed

Explore Related

- Can you explain the different stages of photosynthesis?
- What are the factors affecting the rate of photosynthesis?
- What are the differences between photosynthesis in plants and algae?
- What are some real life examples of photosynthesis?

Can you explain how light intensity affects the rate of photosynthesis?

Imagine sunlight as the fuel for a plant's food-making engine. More sunlight means more fuel, so the engine runs faster, and the plant produces food at a quicker rate. This is how light

Ask me anything



Plan sessions & generate  
AI-crafted lessons



Generate PPTs  
with AI



Generate  
Quizzes & Homework



Video & Topic  
Summarization



Simulations, Graphs  
& Periodic Table



Solve Maths  
Equations using AI



Player for Education  
(Ad-free)



Personal AI Teaching  
Assistant for Students

# Authentic Google Experience



**Google EDLA**  
CERTIFIED



**Google Play**

Access all your favorite apps  
directly on the X2 IFPD



**Google Android 14**

Latest & authentic  
experience



**Google Docs Editor**

Open files directly  
from your X2 Panel using  
any Google Docs Editor



**Optimized Performance with Google Services**

Smooth & efficient  
app experience

Secure & updated  
with Google services



**System Apps**

Pre-installed on X2 series



**Google Play Protect**

Experience Enhanced Security

# All-in-One Teaching Whiteboard

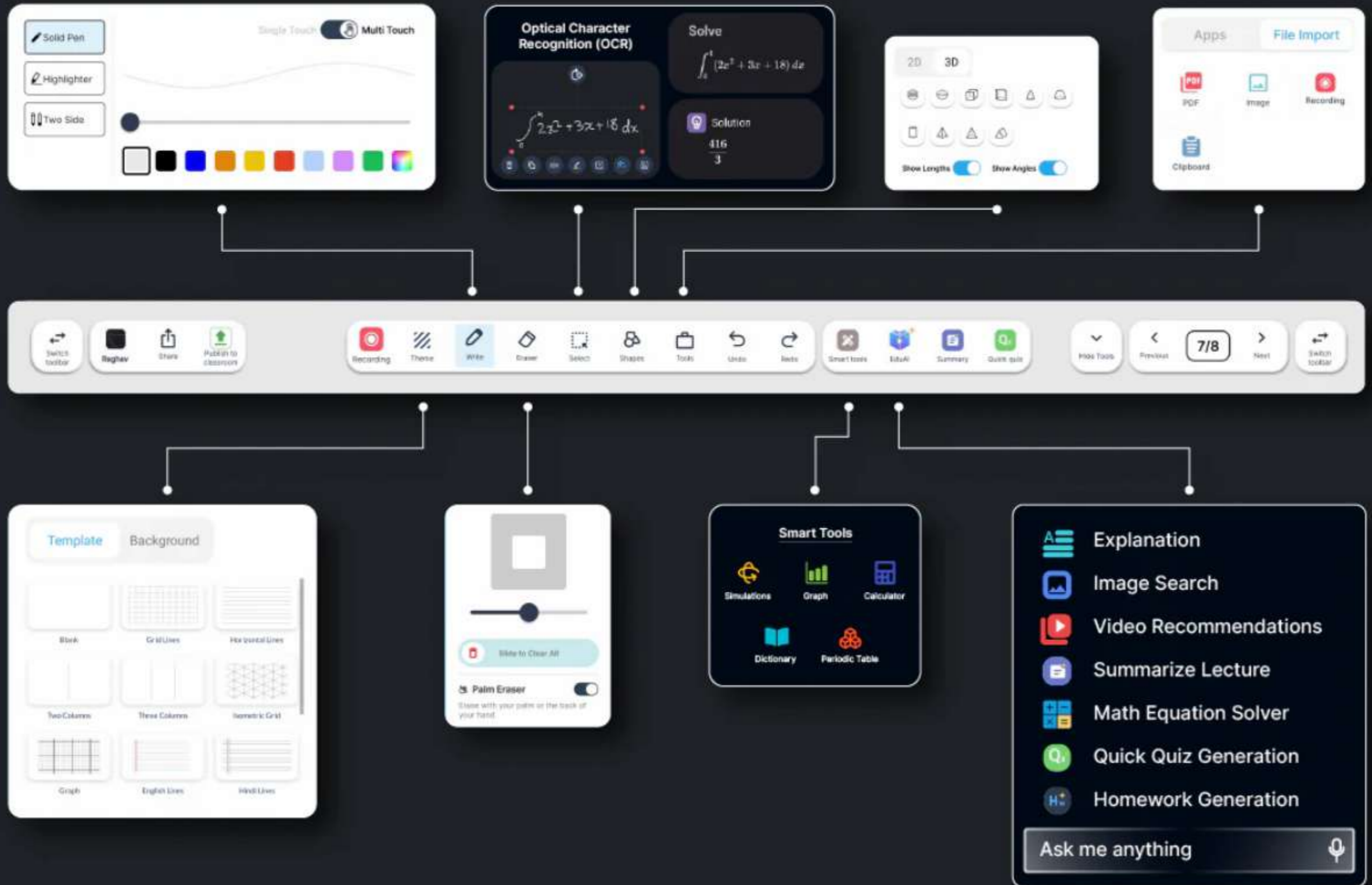

# Powered by Next-Gen Hardware

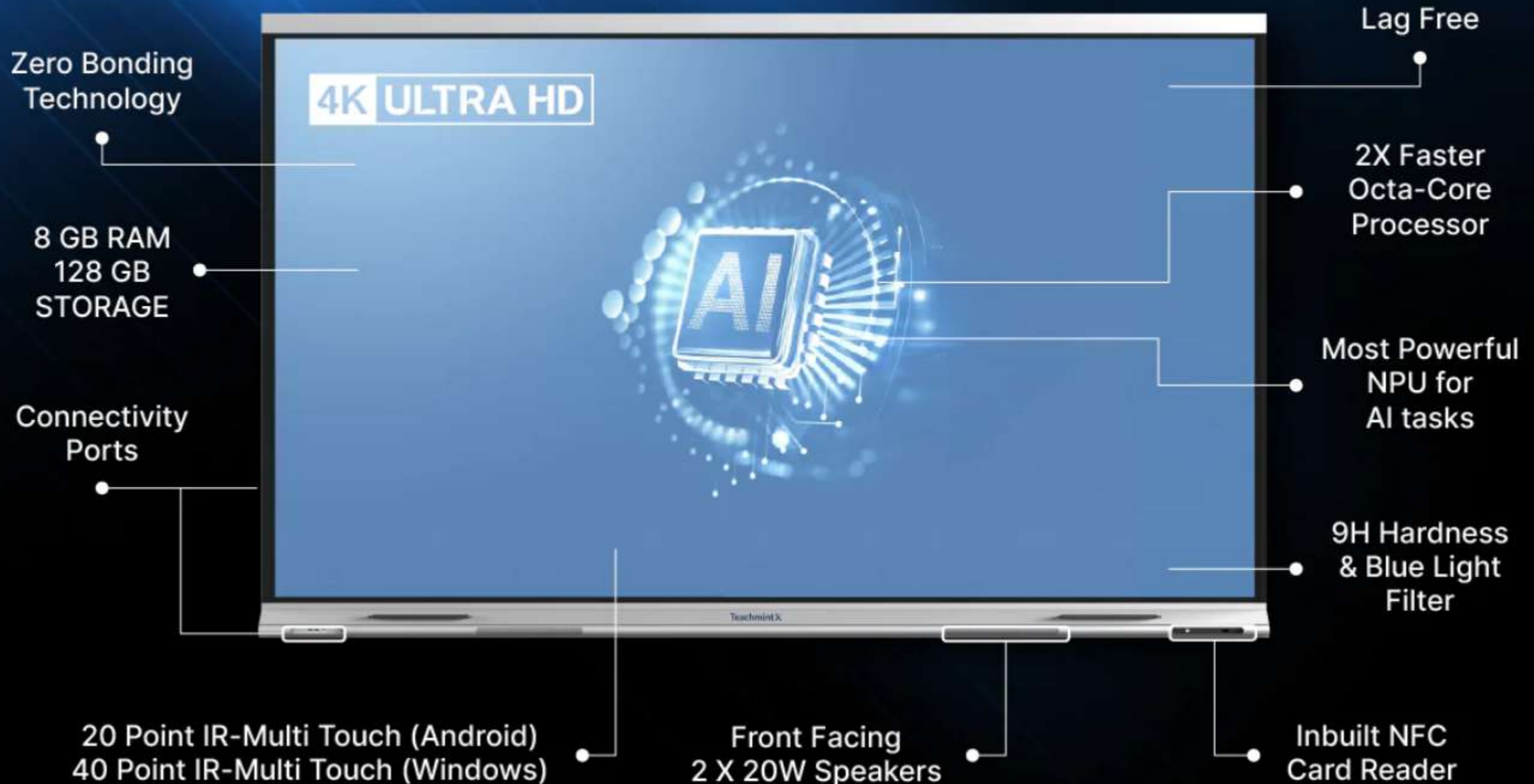

# Connected Classroom App

The screenshot displays the Connected Classroom App interface, organized into three main sections: Pre-Class, In-Class, and Post-Class. At the top left, there are buttons for "Go Live" and "Attendance".

**In-Class Section:** This section is located at the top center and contains four main feature cards: "AI-Powered Teaching Assistant" (with a book icon), "Share Class notes & Recordings" (with a share icon), "Attendance Auto-Synced" (with a laptop and refresh icon), and "Live Class" (with a circular arrow icon).

**Pre-Class Section:** Located on the left side, it includes three feature cards: "Lesson Planning" (with a PDF icon), "Secure Cloud Access" (with a cloud and checkmark icon), and "Create Homework" (with a book and pencil icon).

**Post-Class Section:** Located on the right side, it includes three feature cards: "Assign & Analyze Tests" (with a document icon), "Connect via Chat or Notices" (with a speech bubble icon), and "Class & Student reports" (with a person and bar chart icon).

**Central Panel:** A central white panel is titled "Apps" and "File Import". It contains a grid of nine application icons: "Study Mat..." (green envelope), "Live Class" (gold double arrows), "Homework" (green clipboard), "Attendance" (blue person), "Class Prep" (purple clipboard), "Lessons" (red document), "People" (gold group of people), "Tests" (teal minus sign), and "Report" (gold bar chart).

**Bottom Bar:** A navigation bar at the bottom contains various icons for recording, drawing, erasing, and other classroom management tools. The "TeachmintX" logo is centered at the very bottom.

## Detailed specifications of X2 75" Plus

<b>Model Name</b>	X2 75" Plus	<b>Speaker</b>	Inbuilt Speakers 40 W
<b>Screen Size</b>	75 inch (1.90 m)	<b>Inbuilt NFC Card Reader</b>	Yes
<b>Zero Bonding</b>	Yes	<b>WiFi</b>	Dual Band (2.4GHz & 5GHz)
<b>Display Resolution</b>	True 4K UHD / 3840X2160@60Hz	<b>Hardness</b>	3.2mm Toughened Glass MoHS Level 9 hardness
<b>Processor</b>	Octa Core   RK3576 (4* ARM Cortex A72 @ 2.2 GHz + 4* ARM Cortex A53 @ 2 GHz)	<b>Brightness</b>	400 nits
<b>GPU</b>	MaliG52 MC3	<b>Display Colors</b>	10 Bit / 1.07 Billion
<b>RAM/ROM</b>	8 GB/128GB	<b>Response time</b>	≤5ms
<b>NPU</b>	Onboard AI (6.0 TOPS)	<b>Touch</b>	20 Point IR Multi-Touch (Android) / 40 Point IR Multi-Touch (Windows)
<b>Android Version</b>	Android 14.0 EDLA	<b>Working Life</b>	30,000 Hours minimum
<b>Inbuilt Camera</b>	No	<b>Power Consumption</b>	<380W
<b>Inbuilt Mic</b>	No	<b>Included Accessories</b>	Interactive Flat Panel (1N), Remote Control (1N), Stylus (2N), Power Cord (1N), User Manual (1N), Warranty Card (1N), Installation Docs (3N), HDMI Cable (1N), Touch USB Cable (1N), Wall Mount Kit (1N), Microfiber Cloth (1N), NFC Card (5N)